

# DanPumps S-IP and S-MP Pumps

Industrial and Marine Pumps for safe operations and easy maintenance





## DanPumps S-IP & S-MP

### Product Applications

Danpumps offers a wide range of pumps for any application within the marine, industrial and chemical industries.

### Design

The pump is based on a unique hydraulic design combining maximum efficiency with the highest standards. The pump is based on design according to ISO 2858.

Materials	S-MP	S-IP
Pump house	Bronze/RG10	Cast iron
Back plate	Bronze/RG10	Cast iron
Impeller	Ni.Al.Bronze	Ni.Al.Bronze
Wear rings	Ni.Al.Bronze	Ni.Al.Bronze
Shaft	AISI 329	AISI 329

### Operation Standards

- The volute and the impeller design ensures high efficiency
- Accurate balancing ensures a very low noise level
- Flexible design
- Designed for easy maintenance
- Long lifetime
- Cost optimal
- Connections flanges according to EN1092-1
- Standard colour, Blue RAL 5010. Available in other colours

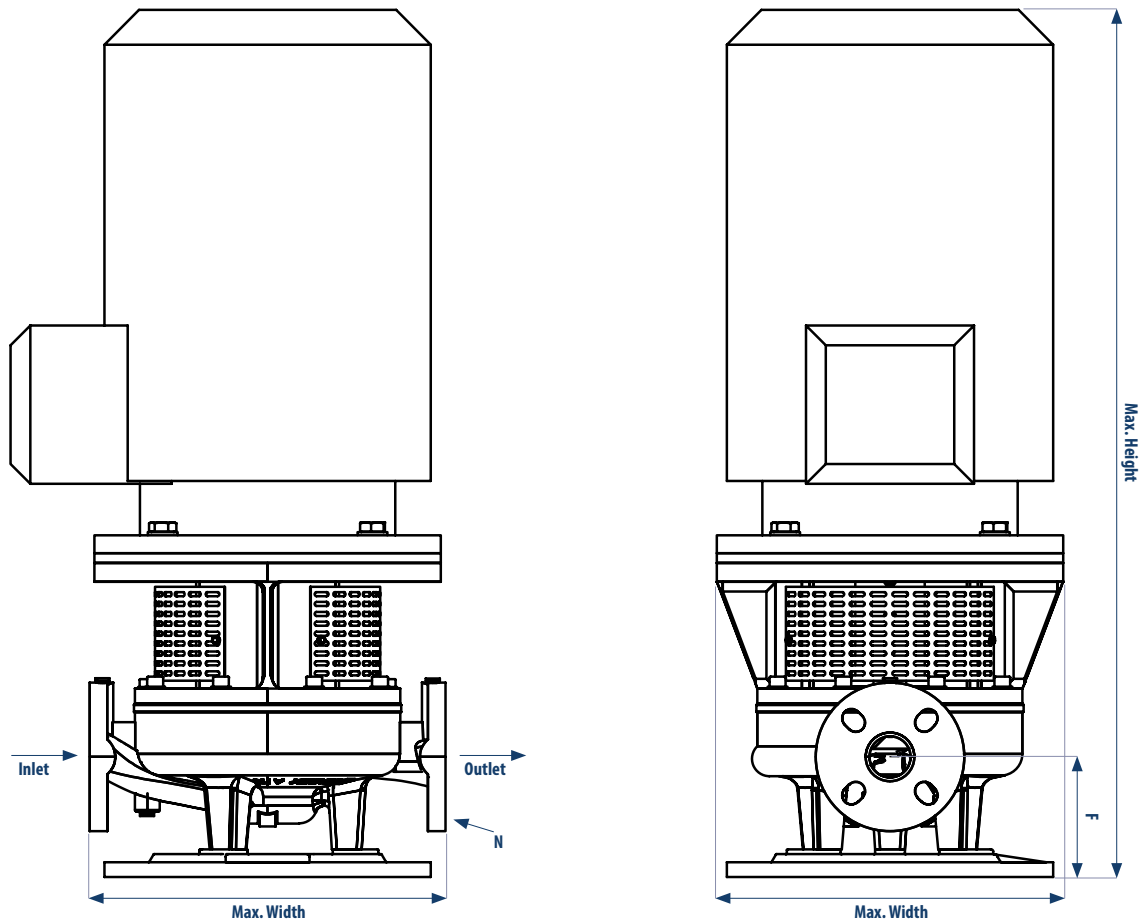

Type	F	Max. Height	Max. Width	Total Length	E (EN1092-1)
S-MP/S-IP 40-40-200	122 mm	821 mm	350 mm	360 mm	DN32 + Dn40, PN10/PN16
S-MP/S-IP 80-80-174	140 mm	965 mm	350 mm	400 mm	DN65/-80/-100, PN10/PN16
S-MP/S-IP 80-80-220	141 mm	1004 mm	350 mm	450 mm	DN65/-80/-100, PN10/PN16
S-MP/S-IP 100-100-220	175 mm	1058 mm	443 mm	500 mm	DN100, PN10/PN16
S-MP/S-IP 100-100-315	157 mm	1139 mm	520 mm	630 mm	DN100, PN10/PN16

Performance Curves - Complete DanPumps-S-MP/S-IP - 50 Hz

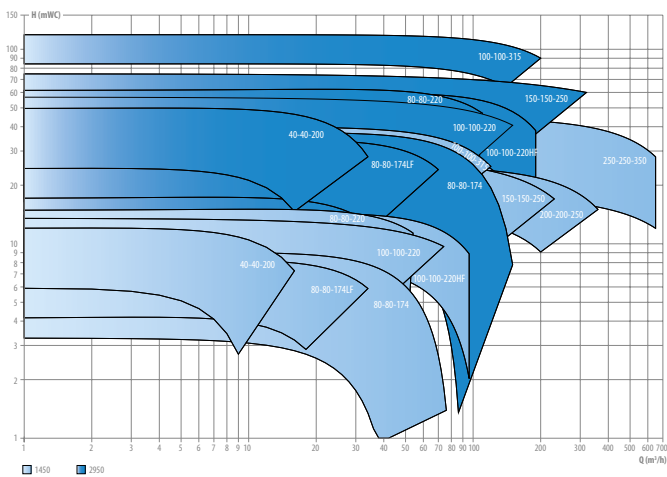

Performance Curves - Complete DanPumps-S-MP/S-IP - 60 Hz

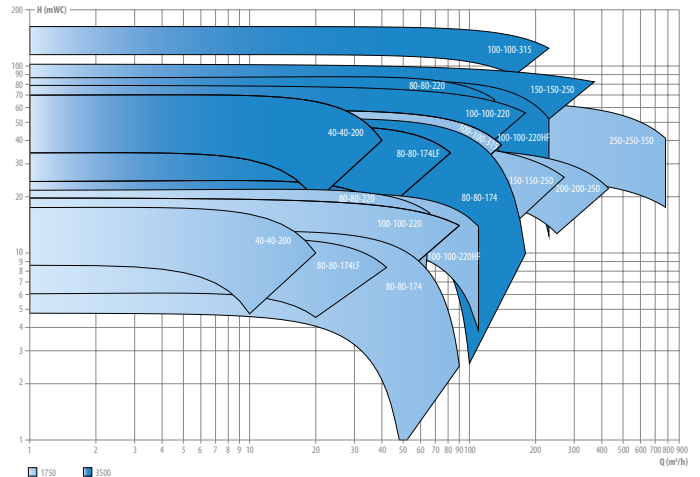



## DanPumps S-IP & S-MP-2L

### Product Applications

Danpumps offers a wide range of pumps for any application within the marine sector as well as industrial and chemical process plants.

### Design

The pump is based on a unique hydraulic design, combining maximum efficiency with the highest standards. The pump is based on the design according to ISO 2858.

Materials	S-MP	S-IP
Pump house	Bronze/RG10	Cast iron
Back plate	Bronze/RG10	Cast iron
Impeller	Ni.Al.Bronze	Ni.Al.Bronze
Wear rings	Ni.Al.Bronze	Ni.Al.Bronze
Shaft	AISI 329	AISI 329

### Operation Standards

- Sturdy design for demanding duties
- Inline pump, easy to remove from rotatory parts - top pull-off principle
- Designed with double bearings between the motor and impeller
- The volute and the impeller design ensures high efficiency
- Low noise level
- Flexible design
- Designed for easy maintenance
- Long lifetime
- Cost optimal
- Connections flanges according to EN1092-1
- Standard colour, Blue RAL 5010. Available in other colours

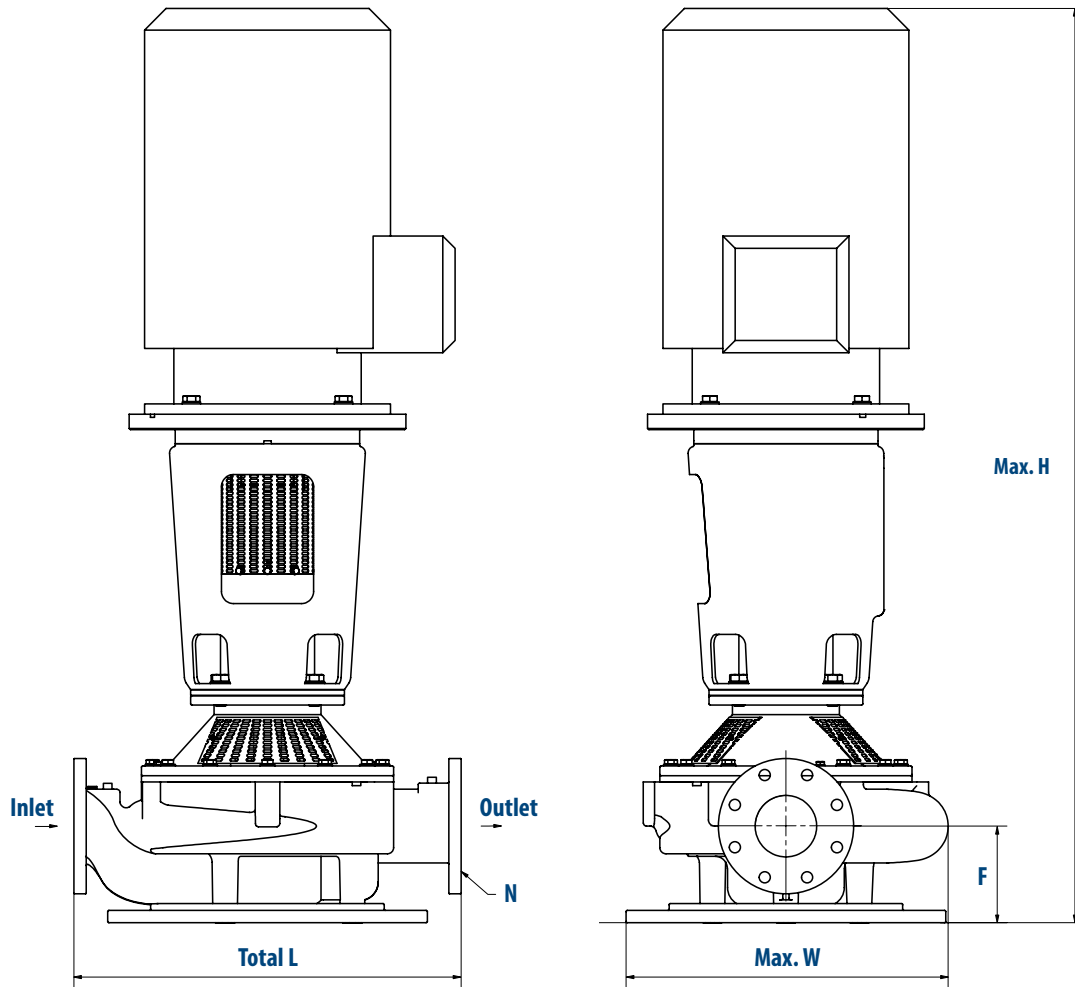

Type	F	Max. Height	Max. Width	Total Length	E (EN1092-1)
S-MP/S-IP 100-100-315-2L	157 mm	1390 mm	630 mm	630 mm	DN100, PN10
S-MP/S-IP 150-150-250-2L	236 mm	1794 mm	547 mm	710 mm	DN150, PN10
S-MP/S-IP 200-200-250-2L	281 mm	1624 mm	600 mm	900 mm	DN200, PN10
S-MP/S-IP 250-250-350-2L	336 mm	2043 mm	705 mm	1000 mm	DN250, PN10

Performance Curves - Complete DanPumps S-MP/S-IP - 50 Hz

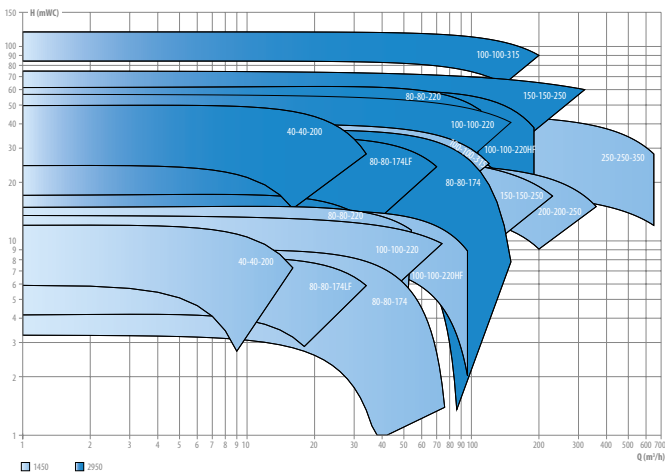

Performance Curves - Complete DanPumps S-MP/S-IP - 60 Hz

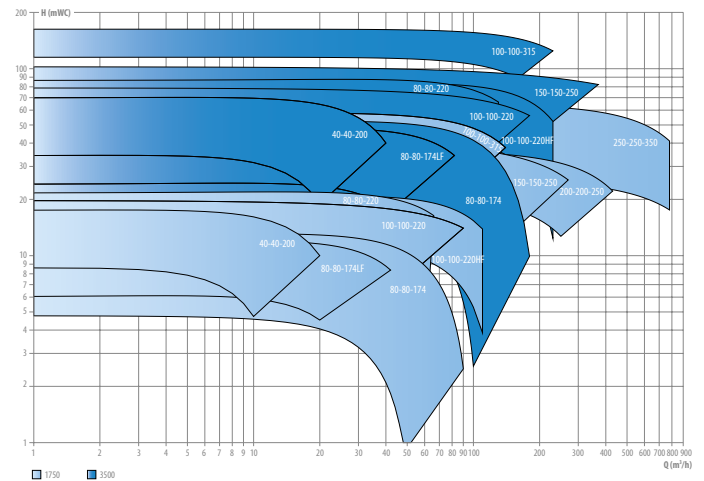

# Example: 250-250-350 Pump



# Example: 80-80-174 Pump

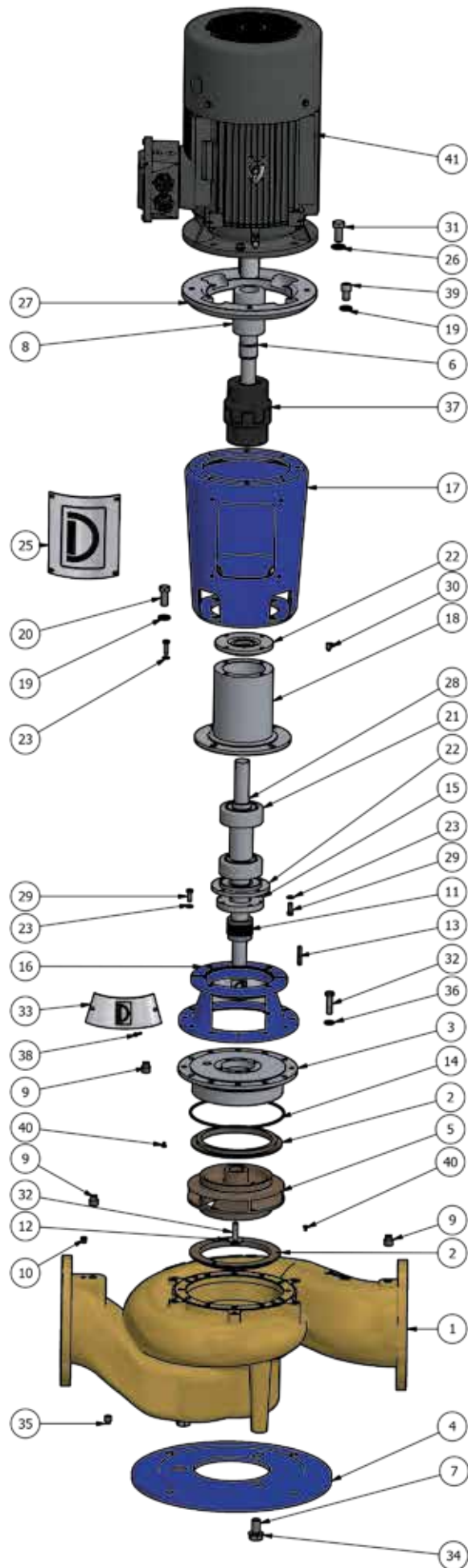



### About DanPumps A/S

DanPumps has been dedicated to providing pumping solutions to utility companies and industries since 2013. In November 2023, DanPumps once again became an independent company, concluding a successful period under SonFlow's guidance. Today, our unwavering commitment is directed towards the development and manufacturing of quality pumps.

### Wide Range of Pumps

The range of pumps at DanPumps A/S is continually evolving, and our ability to deliver customized solutions makes us one of the most flexible and competitive suppliers in the market.

Our pump range is the result of high efficiency, intelligent design, and practical features. These qualities are combined to create user-friendly pumps with a long lifespan. We provide pumps for a wide range of applications, including wastewater, marine, industrial, and sanitary purposes.

