

# Plate Heat Exchanger AF60 Series

AF61, AF62 & AF63

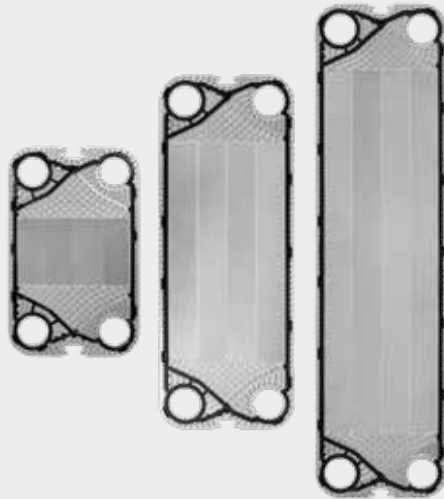

SonFlow



**AHRI CERTIFIED®**  
www.ahrirectory.org

Liquid to Liquid Heat Exchangers  
AHRI Standard 400

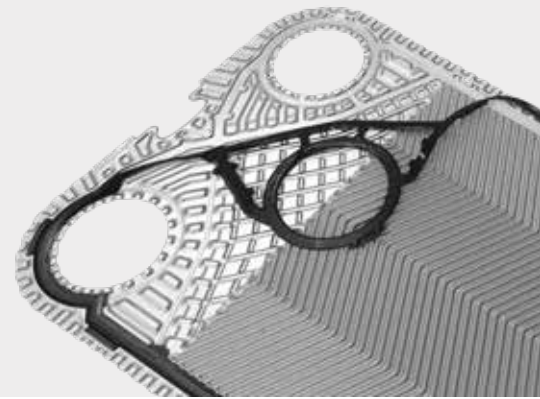

SonFlow offers a wide range of AHRI-certified® products, including the AF60 series. The series is certified in the category of "AHRI Liquid to Liquid Heat Exchangers," which confirms the thermal performance according to the specified specifications. With the AF60 series, SonFlow offers a reliable and efficient single-pass solution that is suitable for many different applications. This is a cost-effective solution that ensures optimal heat transfer and minimal maintenance.

## Typical applications:

- HVAC-R
- General industry
- Marine
- Food & beverage
- Chemical industry
- Mining
- Electronics

- Operating temperature up to 180° C
- Leak chamber
- Fixed bolt head
- Lifting lug
- Lining
- Lock washer

## Features:

Every detail is carefully designed to ensure optimal performance, reduced maintenance costs and decreased downtime:

- Compact design
- High flexibility
- Gentle product handling
- Design pressure up to 25 bar

## Benefits:

- Lower operating costs
- Cost-effective
- Easy assembly
- Increased energy efficiency
- Easy cleaning
- Dead spots, that cause corrosion and fouling are eliminated

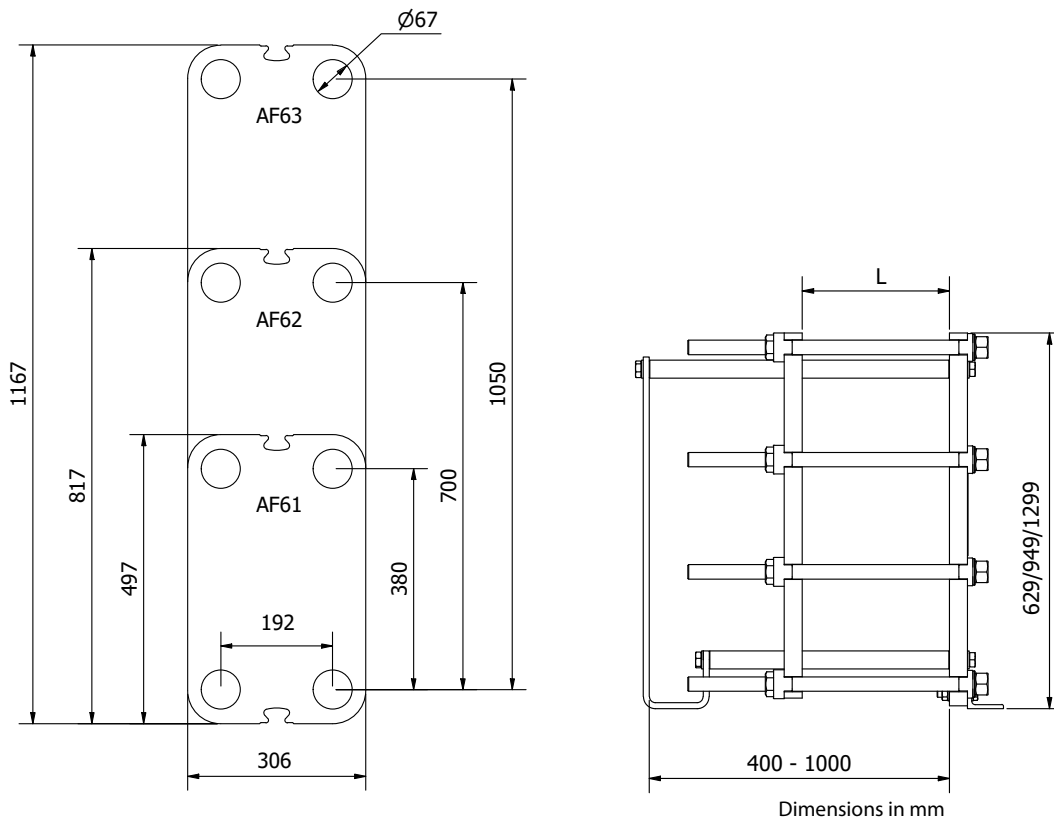

### Design pressure:

- Painted frames: 1.0/1.6/2.5 MPa (145/232/362 PSI)

### Construction standards:

- EN13445
- ASME sec VIII, Div. 1

### Frame:

- Painted frame, RAL 5010 (available in other colours)

### Connections:

- DN 65/2.5" flange in carbon steel, rubber lined or clad with AISI 316 or titanium
- According to all known standards

### Plate material:

- AISI 304/316 and titanium
- Other materials available on request

### Gaskets:

- Hang-on gaskets
- Materials: NBR, EPDM and Viton
- Other materials available on request

### Accessories:

- Drip tray
- Insulation jackets
- Safety cover
- Assembling spanner



AHRI Certified® is the trusted mark of performance for heating, air conditioning, water heating, and commercial refrigeration equipment. To find AHRI Certified products, go to [www.ahridirectory.org](http://www.ahridirectory.org).

### Certificerede products in the AF60 Series

Model	Fluids	AHRI-Ref.
AF61	W, S, PG	217334126
AF61	EG	217336161
AF62	W, S, PG	217334133
AF62	EG	217336132
AF63	W, S, PG	217334121
AF63	EG	217336155

### Fluids

EG = Ethylene Glycol  
W = Water  
S = Seawater  
PG = Propylene Glycol